



Brattleboro IM 091-1(82) Public Meeting

I-91 Bridges 4N & 4S over US Route 5

April 7, 2026

Project Team

- Bob Klinefelter, P.E.
VTrans
Project Manager
- Adam Stockin, P.E.
WSP USA Inc.
Consultant Project Manager
- Tim Polson, P.E.
WSP USA Inc.
Consultant Design Lead
- Delia Makhetha
WSP USA Inc.
Public Information Consultant

Agenda

- Project Overview
- Existing Conditions
- Traffic Impacts
- Schedule
- Public Outreach
- Questions

Project Location



- Exit 1
- I-91 NB and SB over Rte. 5 (Canal St.)

Project Overview

- Rehabilitation project was advertised twice in 2023
- Scope changed due to unsuccessful 2023 advertisements
- Complete replacement of both NB & SB bridges
- Elimination of piers and raised islands in Route 5 median
- Minor interchange improvements
- Utility relocations within work zone along Route 5
- Safety improvements on Route 5



Existing Conditions – I-91 Bridges 4N & 4S

- Bridges were constructed in 1959.
- Existing structures current condition ratings:
 - Deck: 4 – Poor (Bridge 4N), 5 – Fair (Bridge 4S)
 - Superstructure: 6 – Satisfactory (Bridge 4N), 7 – Good (Bridge 4S)
 - Substructure: 5 – Fair (Bridges 4N & 4S)



Traffic Impacts (I-91)

- Install crossovers in the median to maintain 2 SB lanes and 1 NB lane
 - Interstate crossovers are not planned to be used over the winter months
 - I-91 NB bridge will be replaced first (traffic maintained on crossover to existing SB bridge)
 - I-91 SB bridge will be replaced second (traffic maintained on crossover to new NB bridge)

NB Crossover

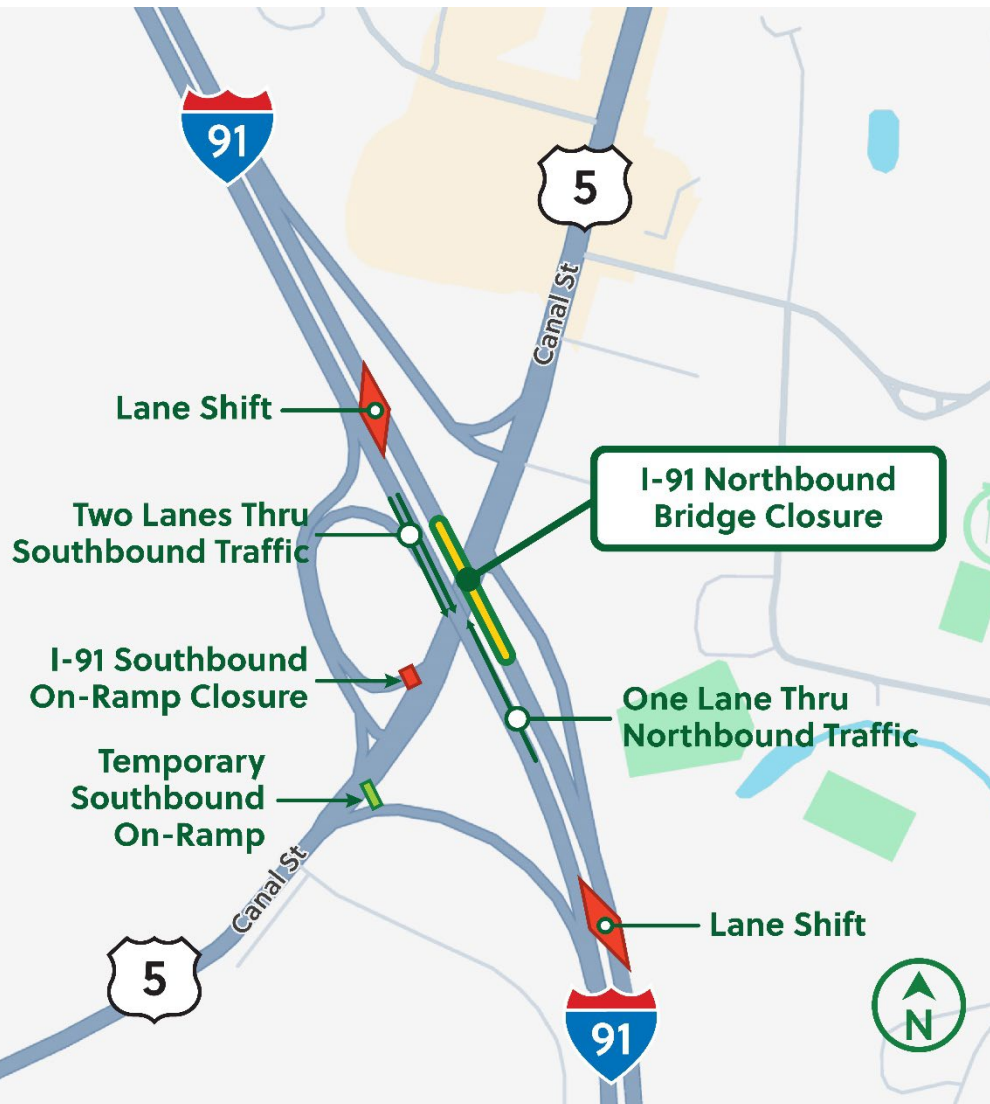

- Two lanes thru SB
- One lane thru NB

NB Crossover

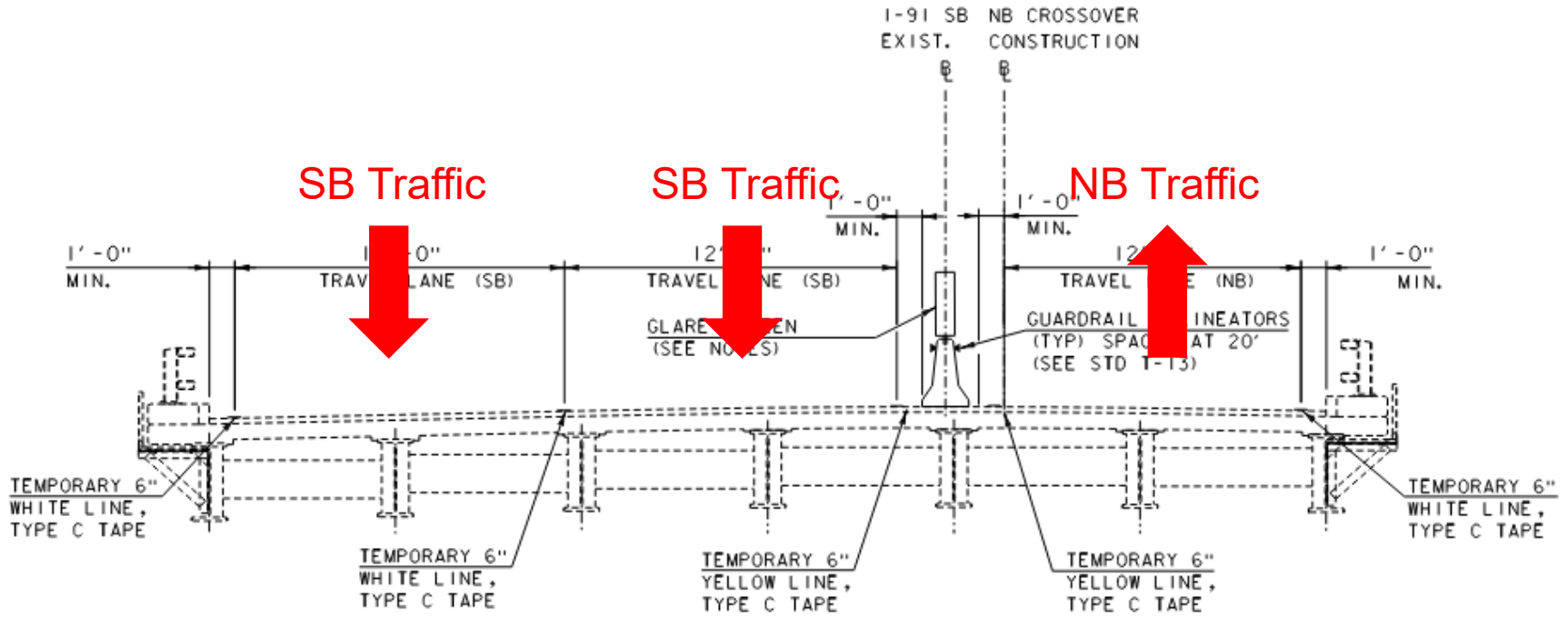

BRIDGE CROSSOVER TYPICAL
(EXISTING BRIDGE DECK - SB)

SB Crossover

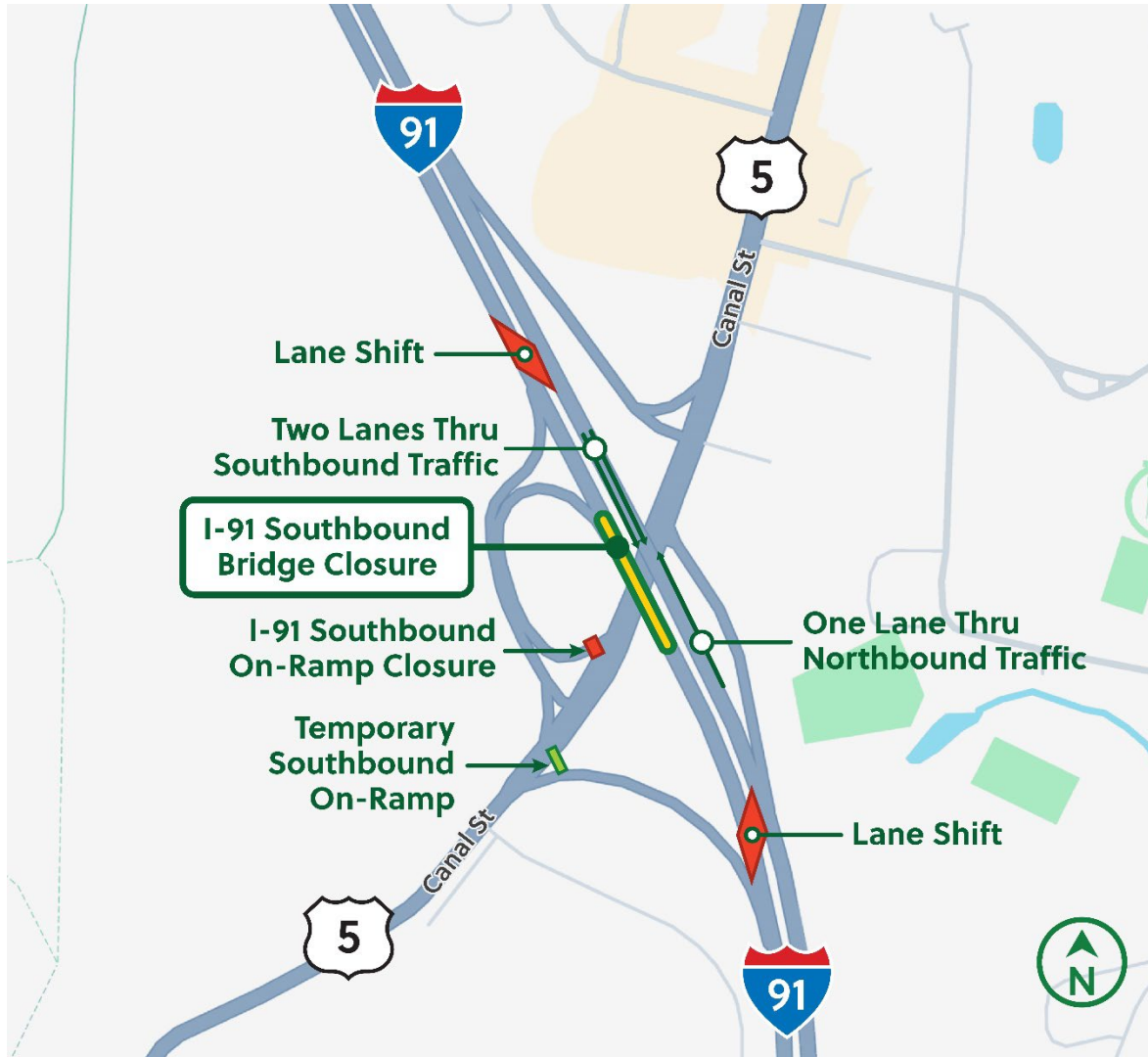

- Two lanes thru SB
- One lane thru NB

SB Crossover

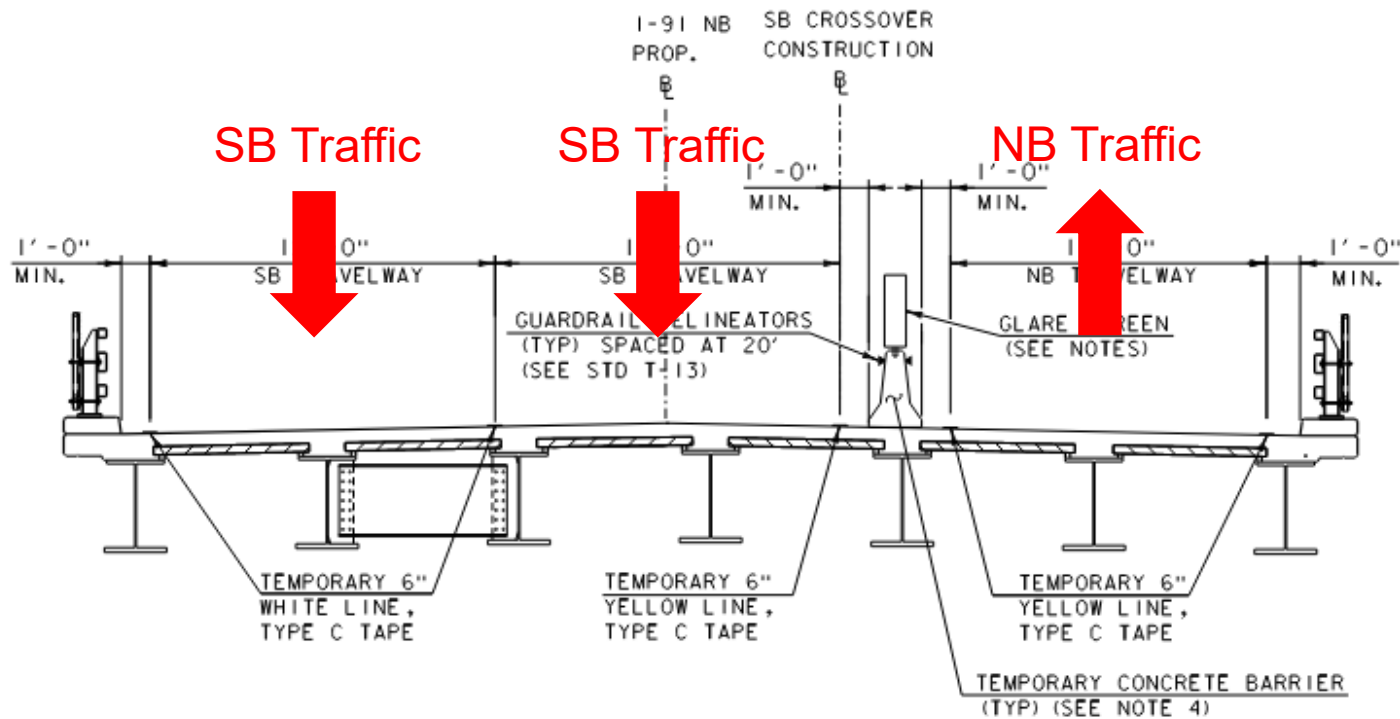

BRIDGE CROSSOVER TYPICAL
(PROPOSED BRIDGE DECK - NB)

SCALE: 1/4" = 1'-0"

Traffic Impacts (Route 5)

- Short duration temporary alternating one-way traffic throughout the course of the project
 - Alternating one-way traffic will be prohibited during the following times:
 - Weekdays: 7:00 AM to 9:00 AM & 2:00 PM to 6:00 PM
 - Weekends: 11:00 AM to 5:00 PM
- Lane shifts on Route 5 to facilitate bridge construction & utility relocation
- SB on-ramp temporarily closed and relocated

Route 5 Work

- Remove raised grass medians

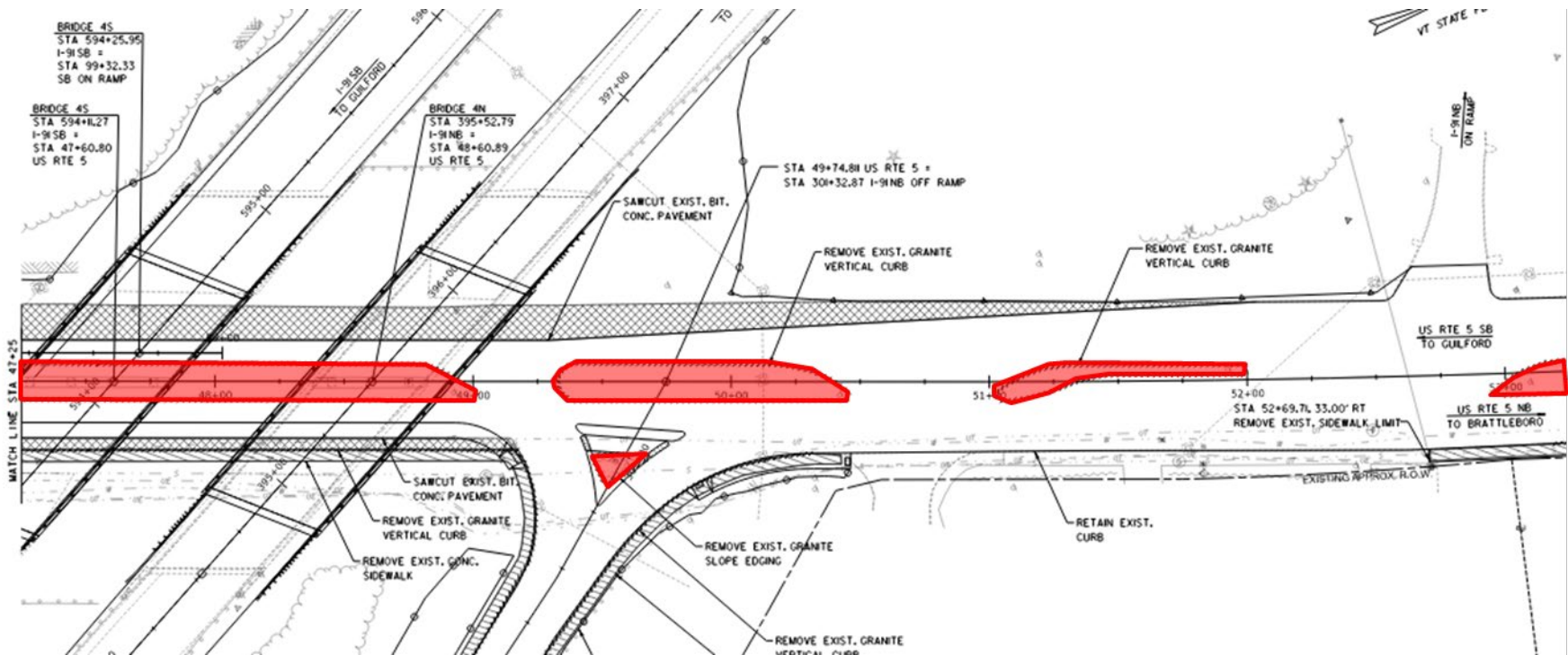

Route 5 Work

- Route 5 under the new bridges & west

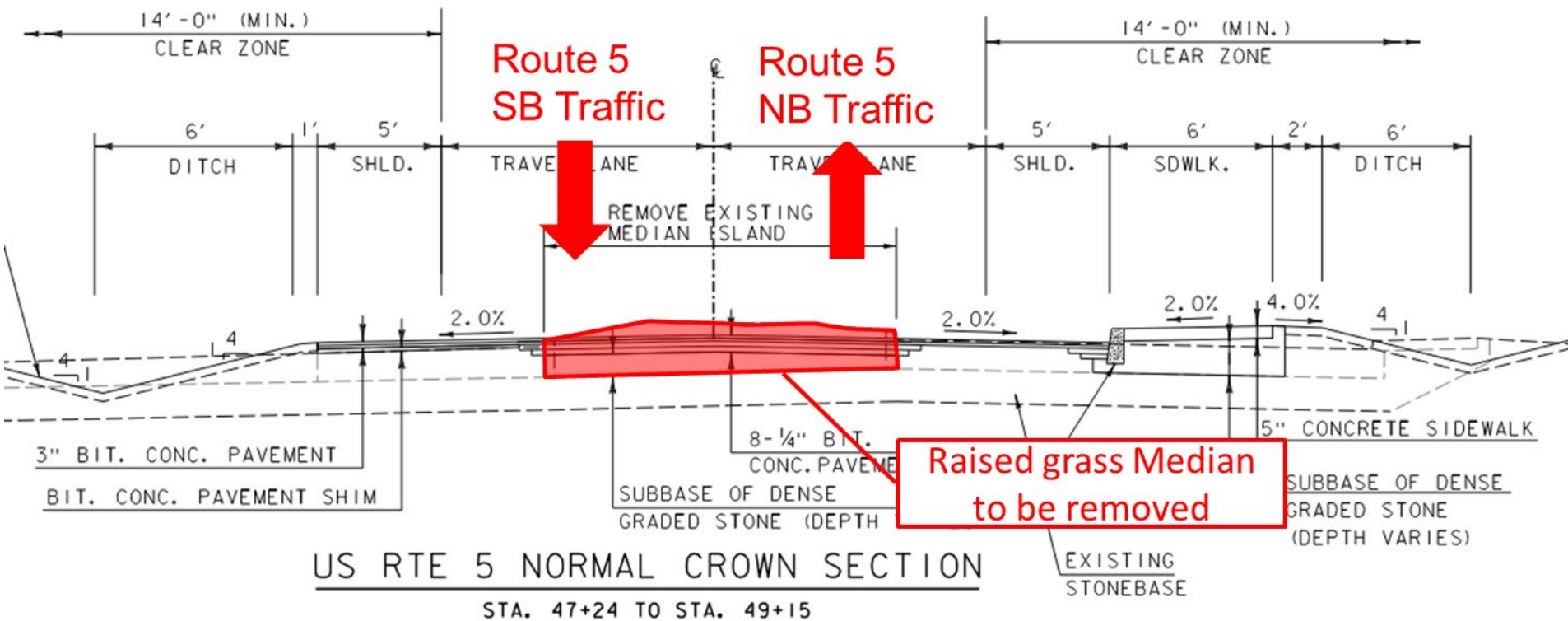

Route 5 Work

- Route 5 east of the new bridges

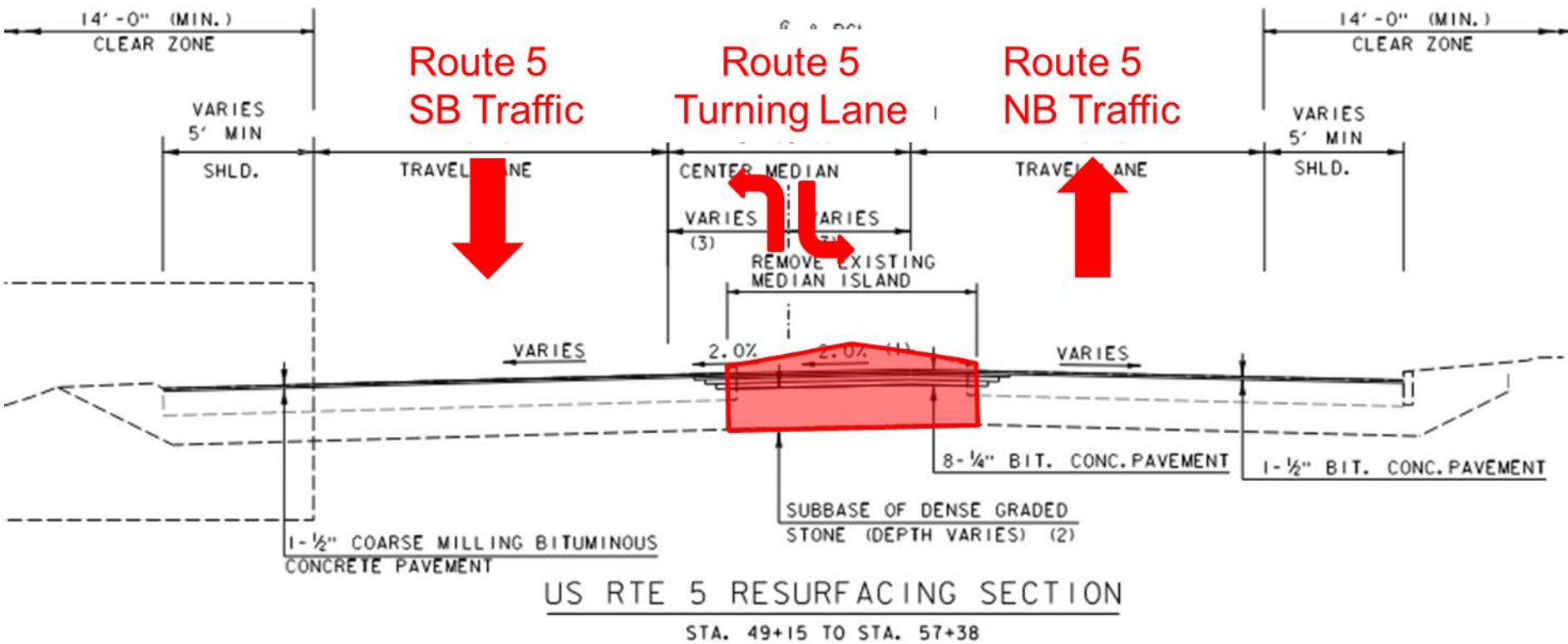

Route 5 Work

- Existing striped lanes: ~16 ft
 - Raised grass medians will be removed.
- Proposed striped lanes: 11-13 ft
- Narrower lanes help promote traffic calming

Route 5 Work

- Potential Sidewalk Extension
- Estimated Non-Participating Cost: ~\$160,000

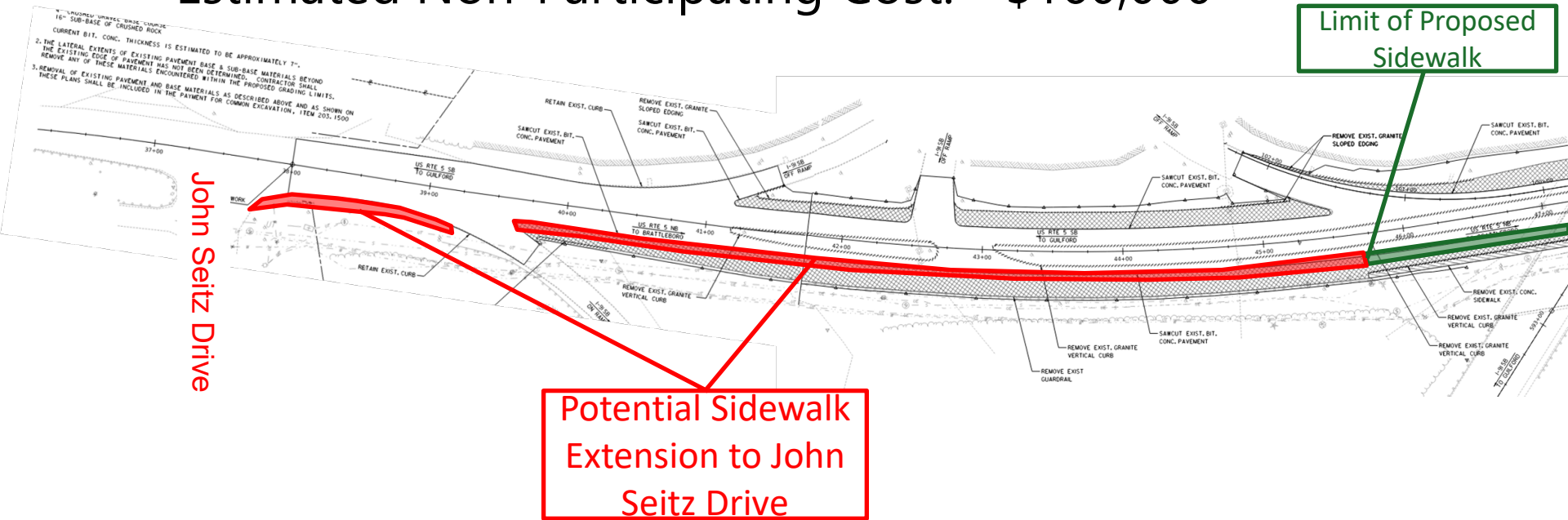

Additional Traffic Impacts



- Temporary closure of the existing I-91 Southbound on-ramp
- Temporary relocation of the I-91 Southbound on-ramp

Construction Schedule

- Project schedule is currently dependent on securing USDOT grant funding
- Anticipated construction schedule (assuming grant award):

Project
Advertisement –
Fall 2026

Construct NB
Bridge –
2028

Project
Completion –
2030

Construct I-91 NB
Median Crossover
& Perform Utility
Relocations on
Route 5 – 2027

Construct
SB Bridge –
2029

Public Information

- Use the QR code or contact the team to sign up to receive weekly Construction Updates
- If you have questions now or throughout construction, contact the project's Public Information Consultant, Delia Makhetha
 - Email: Delia.Makhetha@wsp.com
 - Phone: 603-263-8881
- View the VTransparency Fact Sheet: <https://resources.vtrans.vermont.gov/FactSheet/default.aspx?pin=19A220>



Thank you!

QUESTIONS?